



Department of Physics & Astronomy
Experimental Particle Physics Group
Kelvin Building, University of Glasgow,
Glasgow, G12 8QQ, Scotland
Telephone: + 44 (0)141 339 8855 Fax: + 44 (0)141 334 9029

GLASPE/96{02
7th February 2022

Particle Physics in International Collaboration

D.H. Saxon

Talk given at Kolloquiumstag "125 Jahre Teilchenphysik in Aachen", October 1995

1 The first phase: 1947-1974

The modern era in Particle Physics began in 1947 in Bristol and Manchester, with the discovery of the π -meson, of strange particles, and of muon catalysed fusion [1, 2]. The first paper that describes the strong interactions of a π -meson has only one author [2], but very quickly the advantages of international collaboration came to the fore. Within a year an American balloon (from Oppenheimer) was carrying a British emulsion (from Bristol) into the stratosphere to look for cosmic ray interactions.

Heisenberg's Uncertainty Principle gives the key to everything that follows. The search for the ultimate constituents of matter leads to the search for objects of zero size. (Causality and Relativity together dictate that all finite size bodies must have the possibility of internal movement and so must be composite.) In general then, one is looking for constituents which are smaller than the composites that can be made from them, and the Uncertainty Principle tells us that to access smaller distances one needs higher energies. High energy particles are available in cosmic rays, but in a totally random way so that major investment in detector technology would be needed to get beyond what can be learned from the first observations.

Progress therefore required the construction of high energy accelerators and that needed capital investment. At a UNESCO meeting in Florence in June 1950, I.I. Rabi pointed out the urgency of creating regional centres and laboratories in order to increase and make fruitful the international collaboration of scientists in fields where the effort of any one country is insufficient for the task." This meeting led eventually to the setting up of CERN, the European Organisation for Nuclear Research, initially with twelve member states, and now grown to nineteen. By June 1952 Geneva had been picked as the site for the laboratory, favoured over Copenhagen, Paris and Amsterdam. It is rumoured that the low costs of operating in Switzerland were an important factor.

By the 1960's a pattern had emerged of about ten "state of the art" accelerators at national and international laboratories around the world. The most sophisticated experiments involved the use of bubble chambers. Each chamber was an expensive capital facility capable of producing exquisitely detailed pictures of the reactions of a beam of particles incident on the liquid in the chamber (usually liquid hydrogen), held momentarily in a superheated condition so that fine trails of bubbles formed along the paths of charged particles. By observing the paths, one could infer the motion of the particles, rather as one can observe the passage of aircraft from the vapour trails in the sky. By varying the type and the energy of the incident particle, a wide range of observations could be made. With a production capacity of millions of photographs per year, such a chamber could support a varied sequence of investigations, rather like an astronomical observatory.

One took the film back home to one's institute, to scan and measure with the assistance of skilled young ladies. Usually a group of laboratories came together to make a common project. By sharing the repetitious labour they could increase their measurement capacity and build up a common library of data. They took the film first, over a few days or weeks, and then shared the reels around the collaboration. Problems of optical distortions and the like, which affected the quality of the results, were different on film taken on different dates. Each site therefore took responsibility for certain reels of

film, measuring events of interest not only to themselves, but on processes whose scientific explanation would be elucidated elsewhere. This usually took more than one year, and technical analysis problems had to be solved as they arose during this time. Sharing the development of software tools resulted in both gains and losses in efficiency: some skill in managing a collaborative effort is needed if such a venture is to be coordinated around a set of Universities spread perhaps over two or three countries.

The relatively short time spent at the accelerator taking the film, its transportability, and the fairly standardised nature of the film-analysis technique encouraged collaborative work and allowed the intellectual input of groups from far apart to be brought together to improve the quality of the analysis. The sharing of responsibility for the quality of the data, and the pooling of the data used in each analysis, created a custom that the collaboration publishes its work as a whole. Before one's work can be published, one must convince the collaborators of its validity. There may be competing analyses on the same topics from other groups within the collaboration, and these must be reconciled before the work can be made public. This internal refereeing has done more to raise the quality of the

eld than any other single custom . It also laid the foundations for the thousand-m ember collaborations of today. As always, the external competition from other collaborations is vital, both as a safeguard and as a spur.

My own entry to the eld, in 1966, was in search of a "one-man" experiment. I was afraid of the dangers of the big-science culture. In the event I did complete a bubble chamber experiment substantially on my own, with the advice and help of my supervisor and a sabbatical visitor, but apart from the facilities in Oxford, where I was based, I used laboratories in three countries – accelerators and bubble chambers at Rutherford (UK) and Saclay (France) and measuring and computing facilities at Berkeley (USA). Apart from an education in becoming street-wise during riots in two countries, I mastered such topics as inventing tape formats that were compatible between computers with 60-bit word length (in Berkeley) and 36-bit word length (in Oxford.) 8-bit bytes had yet to make their mark!

Bubble chambers dominated Particle Physics Research in the 1960's. But another style of work grew alongside it, using electronics and spark chambers. This demanded a different culture. Teams of up to a dozen scientists worked long hours for months at a time at the accelerator, mastering technical problems to get a specialised detector ready to measure accurately and with known efficiency a particular process, probably one not accessible to bubble chambering because it demanded, say, measurement of photons or neutrons or the use of a polarised target. I practised this craft between 1974 and 1978. It teaches one how the quality of the detector instrument dictates the range and usefulness of the studies that can be made.

The style of experimentation is driven by the science to be done. Each generation of machines brings in proves in energy or intensity that demand new practices from the experimenters. The start-up of Fermilab (an incremental process around 1972) marks a transitional phase. Experimental teams were still small, but beginning to be challenged by the required advances in technology. I myself went, in common with four other European Research Associates, to work for Columbia – in New York for a year and then at Fermilab, mastering such arts as cable tray and shielding block design! I joined a Columbia-Fermilab experiment led by Leon Lederman, that was looking for the Z and W bosons.

We didn't know then how massive these bosons might be, but we planned to produce them in proton-beryllium reactions at the highest possible energy and intensity and to identify them by their decays to electrons and muons. For the first time we used magnets, calorimeters and presamplers to distinguish electrons and muons from pions that were ten thousand times more common [3]. The work on technique was innovative, and paved the way for much of today's, but our effort was limited to building a spectrometer of modest aperture, and was delayed by poor performance of the accelerator. By April 1974, we had measured successfully inclusive electron and muon production rates as a function of transverse momentum, and we were working to build a second arm for the spectrometer, to detect particles that decayed to a pair of leptons.

We were too late. High energy physics was revolutionised in a single day in November 1974, by the discovery of the J/ψ particle [4]. It was found in two separate ways, by hadronic production of lepton pairs, just the method we had developed at Fermilab [5], and by the study of electron-positron annihilation [6]. The Fermilab group recovered, and pushed on to discover the ψ particle [7], but the success of the electron-positron annihilation work changed not only our philosophy of physics – within a few months the quark model became accepted as the norm – but also the techniques.

2 Colliding beam facilities: 1974 to the present.

"e⁺e⁻ annihilations are rather poor producers of meson resonant states and not likely to contribute much new knowledge of their properties" [8]. In April 1974, one could say this without a qualm. By November, nature had overturned it spectacularly, and for over twenty years electron-positron colliders have dominated the eld. The bosons produced – the γ and Z families and the Z⁰ boson – have been studied with a precision that outstrips virtually all else, and the current standard model is dominated by our knowledge of their properties.

The SPEAR magnetic detector, which was used to make the discovery, is illustrated in figure 1. The SPEAR team could not use a bubble chamber for colliding beams – the target, the duty cycle –

everything was wrong. But they attempted to build a 4π detector which copied its property of seeing all the things which emerged from each reaction, whatever their directions. No-one had attempted such an ambitious thing before using electronic/spark chamber techniques. But this was what was needed to access colliding beam physics, and to build and run it needed 'a new way to do physics' (W Chinowsky, 1974) – the mega-team, in this case twenty-nine people, was here to stay.

By 1977, I knew that my polarised target experiments were coming to an end at the NIMROD accelerator in England, and I needed to look elsewhere for the future. I did one thing right, in deciding to work at PETRA, the new high-energy electron-positron ring being constructed in DESY, Hamburg, to run from late 1978. The lessons of the November Revolution had been well learned, and this was a new step in complexity and in organisation. The detector was full-solid angle. As at SPEAR, one took all reactions simultaneously, with the same democracy as a bubble chamber, but with a new collision to be inspected every 4π s, rather than every two seconds or so. This placed great importance on the event 'trigger'.

One needed to reject unwanted collisions and select wanted candidates at this prodigious rate, and needed to do this in a reliable and understood way, with a known efficiency, known background, and known biases. Electronic logic had developed to the point where complex track-finding triggers could be built to work at this speed. But to make this work in any sensible way, one had to be able to measure the efficiency, to monitor it, and to make improvements. So one needed to reconstruct the results from day one. The lead-time on event reconstruction fell from 18 months to one day, as the trigger experts clamoured for feedback on their performance. The higher energy of the collisions forced every part of the detector to be bigger than at SPEAR.

How to achieve all this? A collaboration of powerful institutes was needed, each with expert teams specialising in certain aspects of the task. In the case of the TASSO collaboration, we began with 87 scientists from nine institutes in three countries: the number of institutes and countries grew a little later. It was a marvellous experience – the thrill of producing new science in all directions, the stimulus of working with enthusiasts from so many places, and the urgency of the competition inside and outside the collaboration, (a spur both to speed and to accuracy,) all combined to raise the level of our work.

A particle physics experiment is a long undertaking, though not perhaps as long as the time scales involved in the design, construction and exploitation of scientific satellites. It starts with a scientific idea, perhaps amongst a group of friends. The development of the detector technique can take over five years – for the quality of the instrument is paramount to the range of the work that can be done. If one takes HERA as an example, meetings on possible electron-proton colliders were held as early as 1975. The subject acquired real momentum (as viewed by this experimenter) in Genoa in 1984, and the first results came in 1992. The full exploitation of the facility will take over ten years.

Particle Physics experiments are like astronomical observatories, in that they permit a range of studies. But by contrast with observatories, each study addresses the entire data sample, accumulated perhaps over several years. Wanted data are selected by triggering and by appropriate cuts in analysis. So different subsystems, designed to measure different aspects of each event, must cohabit without degradation of each others' performance. Thus semiconductor 'vertex detectors' which measure track positions close to the production point must have minimal material to reduce both multiple scattering and photon conversion which would degrade the track momentum and multiplicity measurement.

The more sophisticated results are often obtained by combining results from different detector components. An example from the LEP collider at CERN, producing a Z^0 boson which decays to a quark-antiquark pair, is shown in figure 2. This shows the production of a B_s meson, consisting of a $(b\bar{s})$ quark pair. The B_s decays after travelling about 3 mm, to 0^- . The 0^- then decays to $^+ \pi^-$, and the π^0 to $K^+ K^-$. The main tracking chamber ('time projection chamber') was used to measure the particle momenta, and to identify K -mesons by their ionisation loss, the vertex detector to separate clearly the production and decay of the B_s , the electromagnetic calorimeter identified the electron, and the penetration of the particles through the hadron calorimeter into the muon chambers identifies the $^+ \pi^-$ and the π^0 .

The ALEPH collaboration, which worked together to construct and exploit this elegant detector,

started work in 1982 and now comprises over 400 physicists from 32 institutes in 10 countries.[9] Not all these countries are member states of CERN. People outside the field often ask how such a body is managed. It is done using no documents of greater legal strength than a memorandum of understanding – a document which binds the funding agencies of each country to best endeavours, but is not something on which you could sue. The collaborations operate within a formal structure devised by themselves under the avuncular gaze of the CERN management. In the end, it works because the scientists themselves want it to work. The sanction for failure to deliver results, for poor performance or inadequate maintenance of equipment, or for unethical behaviour is loss of reputation.

The world of Particle Physics is in one sense small. The fear of being drummed out of the club is a powerful sanction, but the very smallness of this world makes it in another sense large. It provided some porosity in the iron curtain long before its rust began to be evident elsewhere, and continues to provide a mechanism for cooperation between both well resourced and poorly resourced countries. Groups from afar that bring little in the way of Swiss Francs can contribute as equal collaborators if they contribute intellectual capital that their partners value.

3 New projects: 1995 on

Investigative science must progress or die. For Experimental Particle Physics this is especially true. Governments will tolerate continuing to pay our bills only if they see continued vigour and advance. Decisions to build new accelerators must be driven by theoretical insights that point the way forward. The need for high energies to study neutrinos impelled the construction of the SPS. LEP was impelled by precisely testable predictions of electroweak theory, HERA by questions on the structure of matter and its interactions, and the Large Hadron Collider by theoretical insight (the Higgs mechanism) on the origin of mass and hints of higher symmetries.

The financial climate has become less congenial. In the 1970's the CERN SPS was built on a dramatically increased annual budget. In the 1980's LEP was built within a constant annual budget. In 1994 CERN Council insisted that the Large Hadron Collider be built within a shrinking budget, with special contributions from the two countries in which the LHC will sit (across the Franco-Swiss border) and with substantial contributions to help and accelerate the construction of the collider from non-member states who wish to share in its exploitation.

One must therefore be ruthless in moving on when a current venture has fulfilled its potential. LEP ran from 1989–1995 as a Z^0 factory and made measurements of unparalleled impact over a range of topics. The precision that has been achieved is legendary and has transformed the style of investigation. The beauty of the measurements that established the sensitivity of the measurement of the Z^0 mass to the tidal distortion of the earth's crust by the moon has subsequently revealed effects due to rainfall, to the height of the water in Lake Geneva, and to the daily passage of trains between Paris and Geneva! The precision of the detectors allowed the identification of processes such as that shown in figure 2, but did not provide sufficient statistical power or sufficient energy to pursue the now-visible goals in fermion and boson physics.

To pursue these goals further two different machines are needed. LEP is being upgraded in stages from 1995 to 1999 to study the W-boson and to search for new phenomena that are hinted at in the Higgs and supersymmetry sectors. The LEP2 machine (as it is called) is a bargain. The LEP accelerator and all its infrastructure is reused with the addition of superlative new superconducting accelerating cavities. (The quality of these can be expressed numerically. An organ playing concert-pitch A and built to the same standard would reverberate for a year after the note was sounded – an acoustic that puts any cathedral in the shade.) The nineteen member states that together pay for CERN can take pride in the centre of excellence they have created that can make these.

The detectors already built for Z^0 studies needed only modest upgrading to handle the higher energies and rates. But the upgrading is also of the highest quality, and its realisation is an example of the way international collaboration works. Consider the ALEPH vertex detector upgrade (an example with which I am familiar.) Compared to the vertex detector used for Z^0 work, this was devised to extend the acceptance so as to make most efficient use of the accelerator, to reduce the

material intercepting outgoing particles whilst providing additional measurements, and to withstand higher radiation doses. The upgraded system has Italian detector elements, French mechanics and British electronics. To minimise material whilst maximising thermal conduction to carry away heat beryllia substrates and diamond-loaded glue were used.

But the trail of quark-physics found by LEP whilst studying the Z^0 cannot be pursued to the needed statistical precision at LEP. This needs a new accelerator optimised for high intensity rather than high energy. The energy (10 GeV mass rather than 90 GeV as at LEP) is optimised to produce B-mesons in a particular controlled way. The topic addressed is vital for our understanding of the Universe. It offers a clue as to how a Big Bang dominated by radiation ('let there be light') could have evolved into one of matter such as we live in now. And it demands a purpose-built accelerator.

A number of European groups are moving to new facilities, most to California to the Babar experiment being constructed at Stanford. Competition with another facility under construction in Japan will guarantee the vitality and quality in the work. Cooperation across the Atlantic is well-developed amongst scientists, though not, it appears, so easily addressed by certain governments whose modes of authorisation and funding are rather different. Cooperation between Europe and Japan has been highly successful (for example at PETRA and at LEP), but the scale has so far been more limited. It is good to see the level of cooperation now begun between Japan and CERN as an augur for the future.

4 The HERA model and the Large Hadron Collider.

The construction of HERA – the Hadron Elektron Ring Anlage – at DESY between 1984 and 1992 provided a working example of the way forward for international and inter-regional collaboration. Germany announced its intention to build the new electron-proton collider and invited other countries who wished to do so to join in the construction. In the event a number did by constructing elements in their own countries that formed part of the machine, most notably the construction of 3 km of superconducting magnets by Italy. Other substantial components were contributed by Canada, France, Israel, the Netherlands and the USA. Major expert assistance was supplied by Poland and China, and Czechoslovakia: the DDR and the United Kingdom also supplied expertise. Countries who did not contribute in a major way to building the machine could contribute to the experiments, but subsequently pay certain running costs.

CERN is following a similar model for the Large Hadron Collider. The full project for an energy of 14 TeV was approved by CERN Council in December 1994. Based on the member-state funding foreseen at that time it will operate at reduced energy from 2004, and at full energy from 2008. Non-member states who wish to use the accelerator are invited to contribute in cash or kind in a way that will bring this timetable forward. The invitation is open, but there is an expectation this time that such countries will indeed contribute to the machine.

Japan responded with an immediate gift of 5B Yen, perhaps with more to follow, and agreements have been reached, or are well advanced, with Canada, Israel, India and Russia. Negotiations with the USA are underway, with a view to reaching an agreement before the progress of the LHC project is scheduled for review in 1997. The somewhat harsher financial climate of the 1990's is part of the explanation of this stiffening of attitude, together with the perception that it is some years since there was a broad balance in the two-way flow of scientists across the Atlantic, at least within the field. The USA continues to offer entry to Babar on the basis of contributing to detector and associated running costs but not to the capital cost of the accelerator and European scientists are certainly keen to work there, though by no means as many as the Americans who want to use the LHC.

But HERA provides a pointer to the future in another and an important way. Table 1 illustrates this. It shows the time intervals at which beam-beam crossings occur at different storage rings, and the expected number of interactions per crossing (HeraB is a high-rate b-physics experiment being constructed at HERA to run in 1997). Every crossing must be interrogated to see if it contains a useful interaction. One can record only a few events per second. HERA puts us for the first time into a situation where the interval between crossings that must be interrogated is less than the time it

takes to make a decision, and in fact less than the time it takes to read the raw data off the detector into a buffer.

Facility	Year	Crossing Interval	Events/crossing
PETRA	1978	3.6 ns	rare
LEP	1989	22 ns	rare
HERA	1992	96 ns	rare
HeraB	1997	96 ns	4
LHC	2004/8	25 ns	25

Table 1: Rates of potential and actual interactions at various storage rings

Real-time event selection and processing is therefore needed. Unwanted crossings must be rejected, and wanted ones identified. These form only one part in 10^4 or 10^7 of the total number of candidate crossings, for a range of relatively common or rare processes. The "trigger" needs high and known efficiency, and the ability to develop to counteract backgrounds or to accept processes not considered at the original design phase. One sits on a learning curve, first from HERA to HeraB to LHC on the use of "pipelined logic" and secondly in the early part of the running of the experiment, on developing triggers of increasing sophistication.

Figure 3 indicates the logic structure proposed for the ATLAS experiment for the large hadron collider [10]. The data flows are tremendous. The event sizes are such that the front-end data flow exceeds that of present day television sets in the whole of Europe. Successive trigger levels have more time to think, and allow increasingly complex logical decisions to be made on the data. Level 3 involves full event reconstruction.

Figure 4 shows the 'learning curve' for the ZEUS experiment. Data flow restrictions force the first level trigger rate (FLT) to be below a few hundred Hz and the output to tape (TLT) to be below about 10 Hz. At the start of running in 1992 the rates for all trigger levels were very similar and independent of the (very low) luminosity (and so were background-dominated). By 1994 the techniques had become much more sophisticated. Rates are far below linear extrapolations with intensity from 1992, whilst a broader range of physics processes is addressed. The lessons for LHC start-up, when a variety of presently foreseen or unforeseen processes will need to be studied that are excluded by simply selecting on the highest transverse energy, are clear. The HeraB experiment will provide the next test of these triggering ideas [11]. From 1997 four events every 96 ns will have to be tested to see if they are the 1 in 10^5 in which b-quarks are produced.

To handle the energy, the rate, and the complexity of the events the LHC experiments will also be large and complex. Figure 5 illustrates the structure of the CMS experiment [12], and figure 6 shows a typical simulation of an event reconstructed in the ATLAS inner tracker. The technical demands imposed by the LHC on detector technology have stimulated work on detector Research and Development across the whole of the CERN user community, whether on radiation hard semiconductor pixel detectors, high resolution electromagnetic calorimetry, fibre-optic data links, object-oriented programming, cooling and alignment or parallel computing [13]. The 'technology-foresight' and industrial links provide a valuable spin-off from the field.

5 The outlook.

The LHC marks perhaps a transitional phase into world-wide collaboration. Some 30% of the signatories to the two proton-proton experiments are from non-member states. There are 73 nationalities working in institutes in 54 countries. Of these the USA accounts for 507 people. Russia 362, Canada 60, India 42, Japan 38, China 34, Georgia 31, Belarus 28, Israel 22 and Bulgaria 22. All have different

local resources, histories and possibilities. No single structure for cooperation agreements will suit all these. The political dimensions have developed both within countries and in supranational structures.

The European Committee for Future Accelerators (ECFA) has provided an important forum for developing proposals for new machines, whether at CERN or elsewhere. It has a brand-new counterpart in Asia (ACFA). The International Committee for Future Accelerators (ICFA) provides a mechanism for cooperation between the directors of major accelerators world-wide. ICFA has blessed the formalisation of collaboration on the development of accelerator techniques for future linear electron-positron colliders: 23 laboratories in Asia, Russia, USA and CERN member states are involved. Comparison of LEP and the Tevatron shows that the reach in energy of the proton machine is higher, but that electron machines can grasp specific topics with great precision. The top-quark discovery [14] creates complementary virtues in proton-proton and electron-positron machines. To reach energies of 250 GeV or more in a reasonable length (say 20 km) accelerating fields over 10 MV/m are needed, and at a cost we can afford. Once this technical work has succeeded, it is more than likely that the strong support of laboratory directors in several major countries will be needed if such a project is to gain the required breadth of support across governments.

The alternatives to cooperation are atrophy, or at best external direction and delay. The OECD Megascience Forum has looked at Particle Physics, and has flirted with the idea of baskets of projects across a range of fields. (Reference [15] provides some background.) This might be attractive at a time of rapidly increasing wealth, but can run into the sand at times of stringency. The International Union of Pure and Applied Physics has argued strongly that science should not be the exclusive preserve of the wealthiest nations.

One of the products of Particle Physics most valued by governments is highly trained manpower. In the United Kingdom it is viewed in the following way. Students commence Ph D training at age 22 after four years of undergraduate training. They are financed for three years, and expected to complete their work promptly. Indeed the Universities are subject to penalties if students take more than four years. Compared with countries where the Ph D takes much longer, there are plenty of good applicants and when they finish their Ph D's their training is valued by employers. Working in a multinational collaboration gives them leading-edge technical skills, project management skills, communication skills, team-working skills and self reliance. With Physics in its present stage of evolution, we have an excellent case for the number of research students to be increased.

Throughout the changes in Particle Physics since 1947, our techniques have always pursued the most advanced technology. We must conclude that international collaboration has proved a robust tool. It increases both the strength and the quality of the activity. Particle Physics has maintained its vigour, its scientific excellence, and its educational value. It has withstood rigorous scrutiny. We have every reason for confidence in the future, provided that we understand the changing environment in which our work takes place.

References

- [1] B Foster and P H Fowler "40 years of Particle Physics" (Adam Hilger, 1988), and the following original sources: Conversi, Pancini and Piccioni, Phys. Rev. 71 (1947) 209; G P S Occhialini and C F Powell, Nature 159 (1947) 186; C M G Lattes, H Muirhead, G P S Occhialini and C F Powell, Nature 159 (1947) 694; Marshak and Bethe, Phys. Rev. 72 (1947) 506; V Weisskopf, Phys. Rev. 72 (1947) 510; C M G Lattes, G P S Occhialini and C F Powell, Nature 160 (1947) 453; Frank, Nature 160 (1947) 525; G D Rochester and C C Butler, Nature 160 (1947) 855
- [2] D H Perkins, Nature 159 (1947) 126
- [3] M H Bourquin and D H Saxon, Nucl. Instr. Meth. 108 (1973) 461 J A Appel et al, ibid 127 (1975) 495
- [4] M R Jordan "The Hunting of the Quark" (Simon & Schuster - Touchstone, 1987)
- [5] J J Aubert et al, Phys. Rev. Lett. 33 (1974) 1404
- [6] J E. Augustin et al, Phys. Rev. Lett. 33 (1974) 1406
- [7] S W Herb et al, Phys. Rev. Lett. 39 (1977) 252
- [8] W Chinowsky in "Experimental Meson Spectroscopy-1974" (Am. Inst. Phys, 1974) 124
- [9] D Decamp et al, ALEPH Collaboration, Nucl. Instr. Meth., A 294 (1990) 121, ibid. A 360 (1995) 481
- [10] Atlas Technical Proposal, CERN/LHCC/94-43 (1994)
- [11] HeraB Proposal, DESY-PRC 94/02 (1994). HeraB design report, DESY-PRC 95/01 (1995)
- [12] CMS Technical Proposal CERN/LHCC/94-38 (1994)
- [13] CERN Detector R & D Programme 1990-1994 CERN/DRDC 94-48 (1994)
- [14] CDF Collaboration F Abe et al, Phys. Rev. Lett 74 (1995) 2626 ; D0 Collaboration S Abachi et al, ibid. 74 (1995) 2632
- [15] M Jacob, H Schopper (eds) "Large Facilities in Physics", World Scientific (1995)

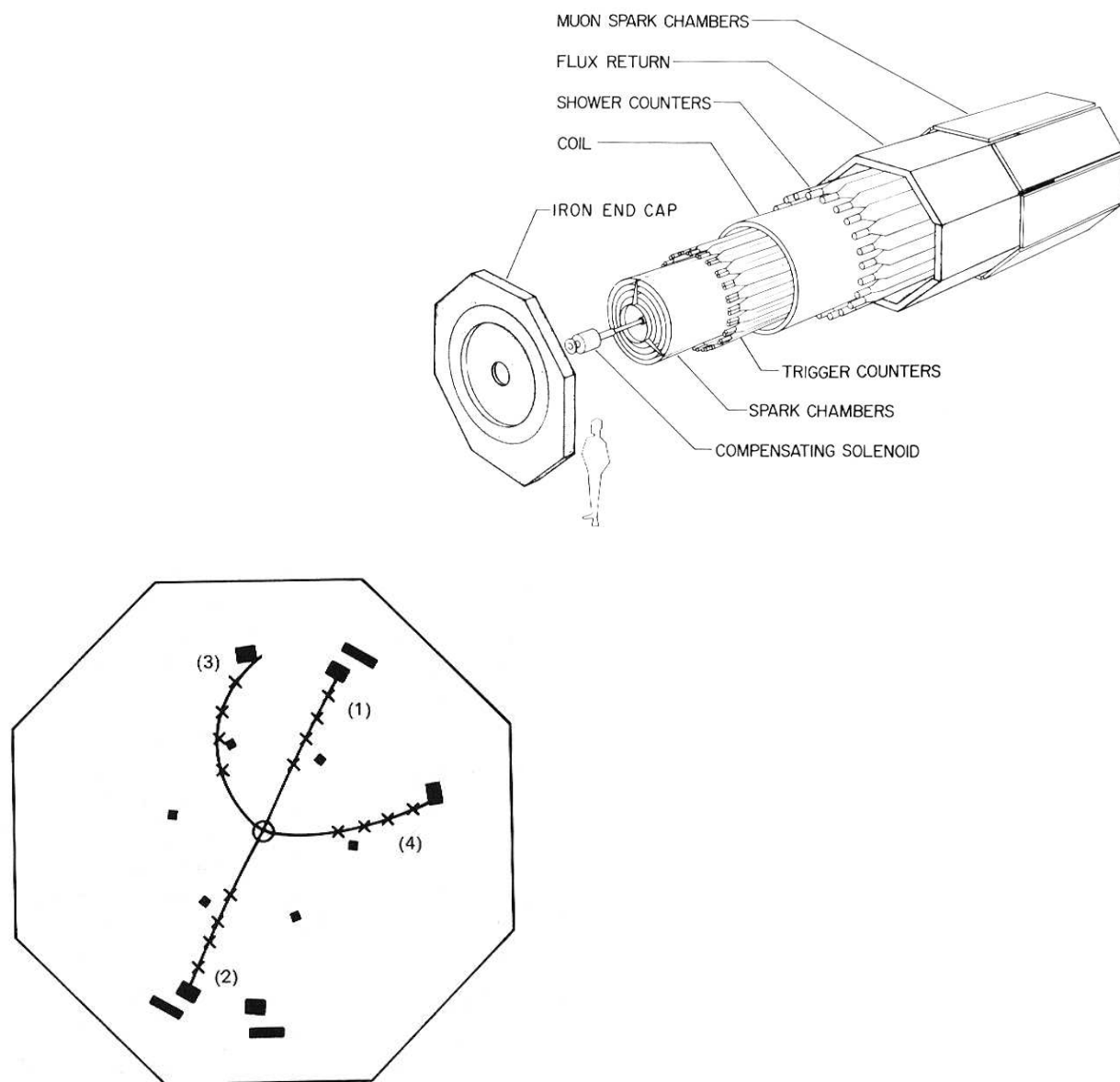

Figure 1: SPEAR magnetic detector. (a) schematic layout (b) a event of the type $e^+e^- \rightarrow \pi^0 \pi^+ \pi^-$. From the pattern of tracks, this was jokingly called the 'auto-signature' mode of the .

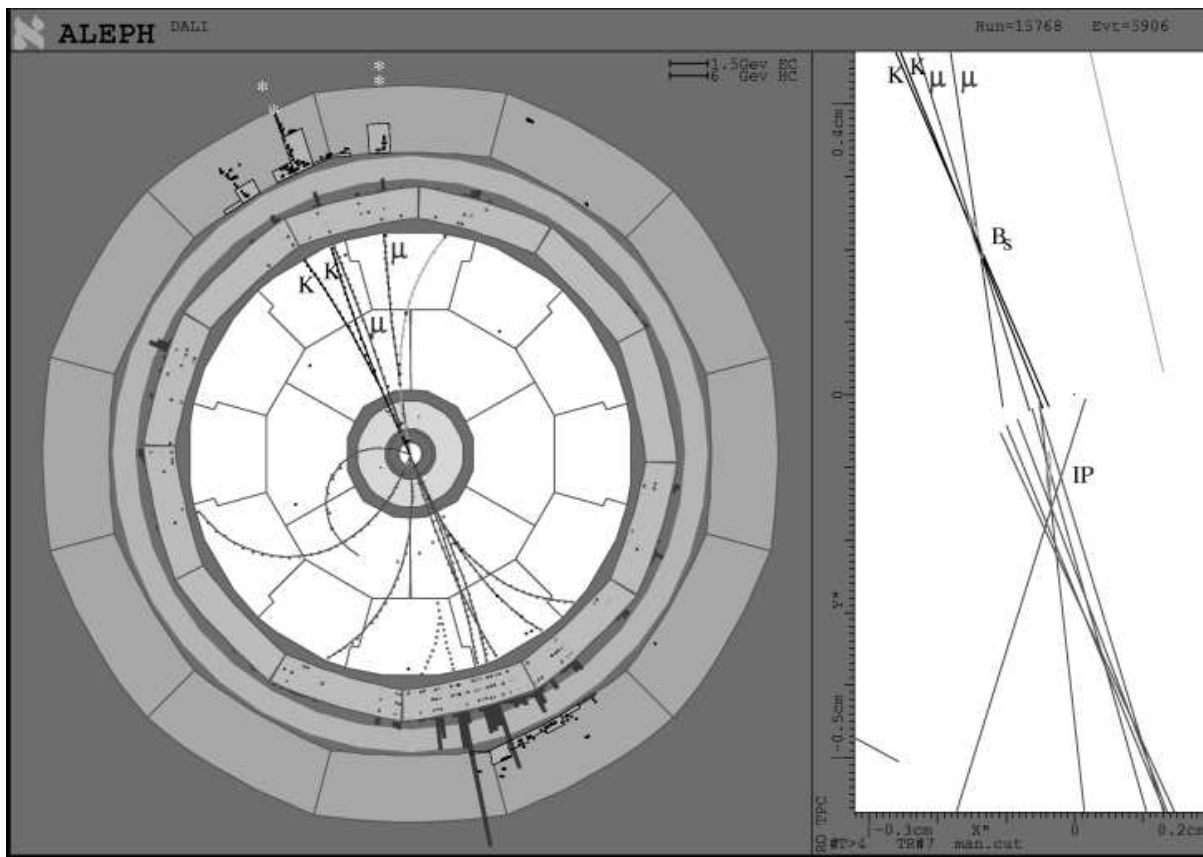

Figure 2: An event reconstructed in the ALEPH detector - main view is of the event seen in the Time Projection Chamber, with the electromagnetic calorimeter, hadron calorimeter and muon detectors in successive layers around it. The vertex region, as reconstructed using the vertex detector is shown on the right, with a 3m light path from the interaction point to the B_s decay vertex. See text for details of the event.

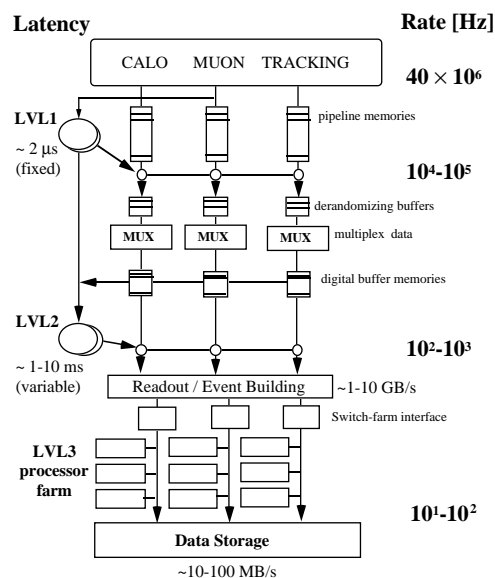

Figure 3: Trigger and Data Acquisition structure of the ATLAS experiment being developed for the LHC

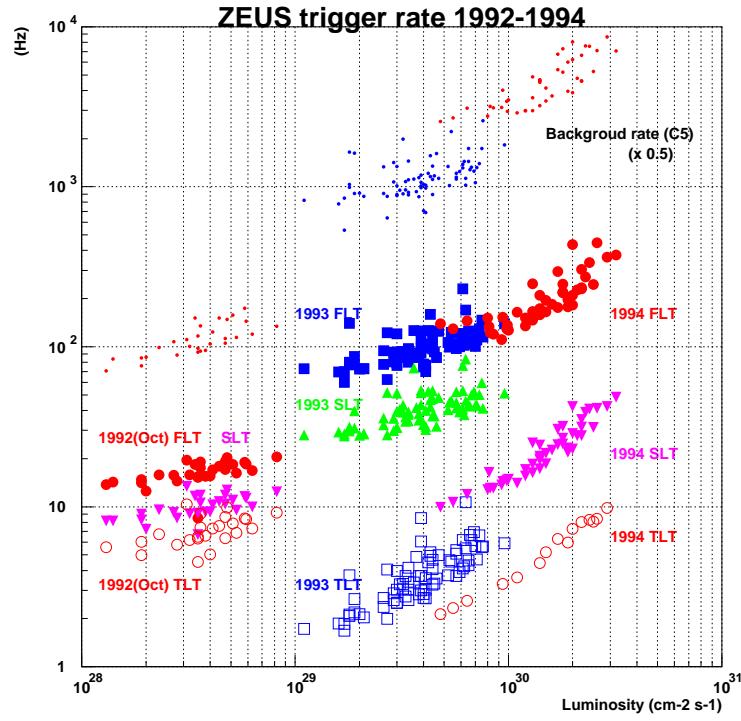

Figure 4: ZEUS (HERA) trigger rates as a function of luminosity. FLT – first level trigger, SLT – second level trigger, TLT – third level, output to tape.

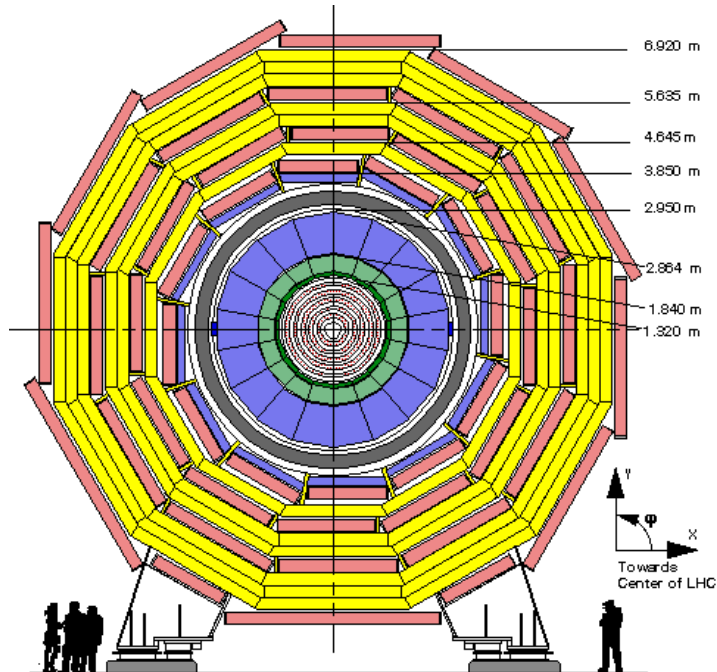

Figure 5: Layout of the CMS detector as proposed for the LHC

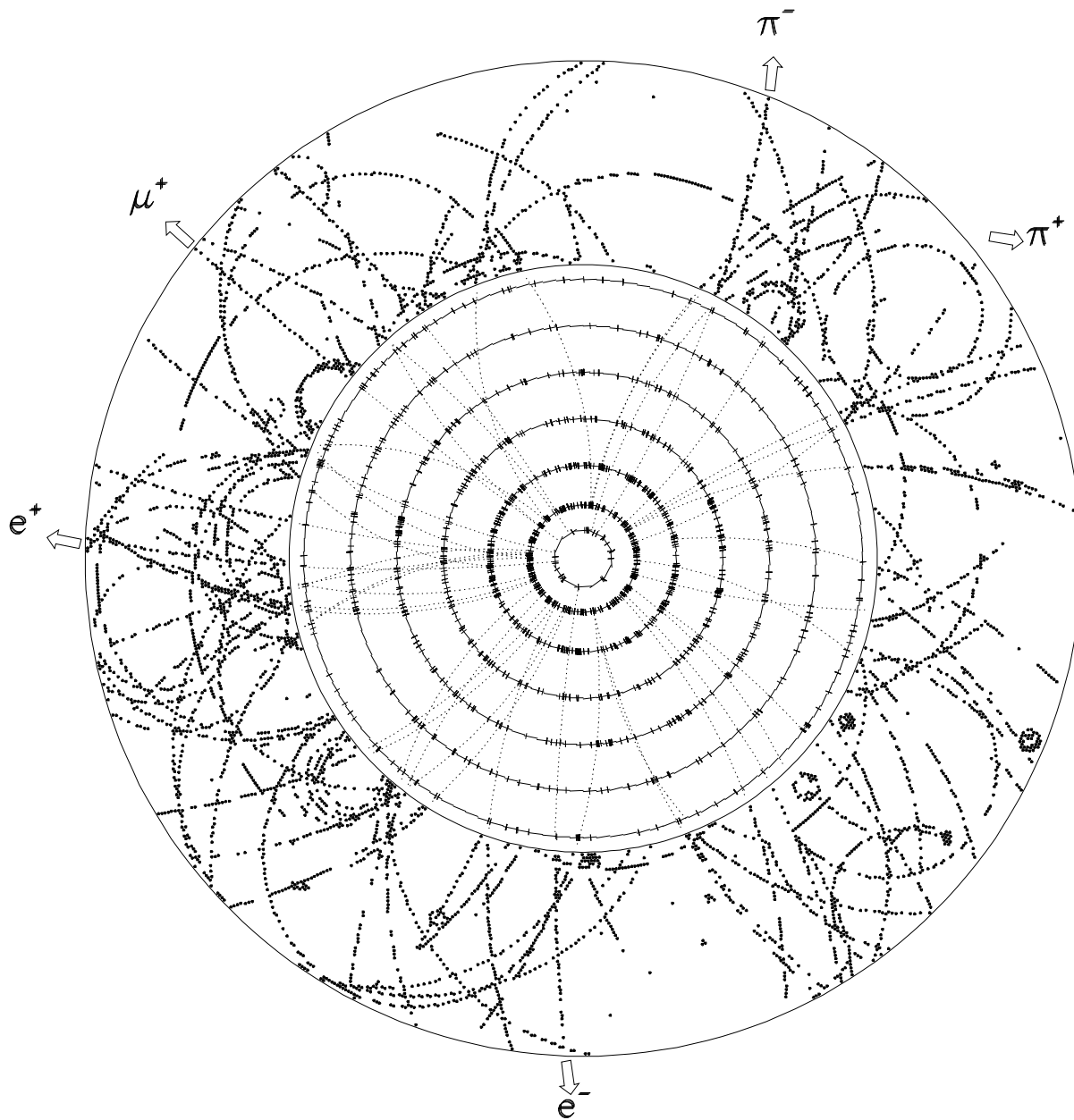

Figure 6: A simulated event pictured in the central part of the ATLAS inner detector. The inner layers are silicon tracking detectors with 80 μm granularity. The outer layers are 4 mm diameter proportional drift tubes ('straw s'). The event shown is at a luminosity of $5 \cdot 10^{33} \text{ cm}^{-2} \text{ s}^{-1}$, and includes the production of a B_d^0 meson decaying to $J/\psi K_s^0$, with $J/\psi \rightarrow e^+ e^-$; $K_s^0 \rightarrow \pi^+ \pi^-$.