

# PLANET: A Collection of Benchmarks for Evaluating LLMs’ Planning Capabilities

Haoming Li,\* Zhaoliang Chen,\* Jonathan Zhang, Fei Liu

Computer Science Department, Emory University

{haoming.li, david.chen2, jonathan.zhang2, fei.liu}@emory.edu

## Abstract

Planning is central to agents and agentic AI. The ability to plan, e.g., creating travel itineraries within a budget, holds immense potential in both scientific and commercial contexts. Moreover, optimal plans tend to require fewer resources compared to ad-hoc methods. To date, a comprehensive understanding of existing planning benchmarks appears to be lacking. Without it, comparing planning algorithms’ performance across domains or selecting suitable algorithms for new scenarios remains challenging. In this paper, we examine a range of planning benchmarks to identify commonly used testbeds for algorithm development and highlight potential gaps. These benchmarks are categorized into embodied environments, web navigation, scheduling, games and puzzles, and everyday task automation. Our study recommends the most appropriate benchmarks for various algorithms and offers insights to guide future benchmark development.

## 1 Introduction

LLM agents have garnered significant attention recently for their ability to automate workflows (Shinn et al., 2023; Liu et al., 2023; Xu et al., 2024; Wei et al., 2025). They are designed to operate autonomously over extended periods and utilize various tools to perform complex tasks. Notable examples of use cases include Salesforce’s AgentForce, OpenAI’s Operator, Microsoft’s AutoGen, LangGraph from LangChain, and Amazon Bedrock’s AI agent framework.<sup>1</sup> **A core capability of these LLM agents is planning (Russell & Norvig, 1995)**, which involves breaking down high-level goals into a sequence of low-level, actionable steps to function effectively. With their popularity, there is an increasing need for comprehensive benchmarks to fully assess their potential.

A key property of planning is that it operates in a decision-making framework where **states are defined, actions transform those states, and a sequence of actions is constructed to transition from an initial state to a goal state**. For example, in ALFWorld (Figure 1; Shridhar et al. 2020b), a household robot performs a series of actions, from ‘*goto the stove*’ and ‘*take the pan from the stove*’ to achieve the goal of ‘*put the pan on the dining table.*’ In this work, we survey a diverse set of benchmarks that adopt this formalism, from embodied agents (Puig et al., 2018; Yang et al., 2025b), to puzzles (Yao et al., 2023b; Lehnert et al., 2024) and web navigation (Deng et al., 2023; Mialon et al., 2023; Zhou et al., 2024b).

Another defining property of planning is **the presence of constraints (Kartam & Wilkins, 1990; Ju et al., 2024; Chen et al., 2024c; Hao et al., 2025; Wu et al., 2025)**. Planners often work with limited resources, incomplete information, or dynamic environments, which require balancing competing objectives or handling uncertainty. For example, trip planning must consider budget and time constraints, with replanning needed for flight delays (Xie et al., 2024a). Incomplete information, such as unpredictable traffic patterns, means the planner must dynamically adjust routes. Planning also emphasizes generality: **the solution (e.g., a plan or policy) is typically reusable across similar problem instances**, distinguishing it from ad-hoc problem-solving methods.

\*Equal contribution.

<sup>1</sup>[salesforce.com/agentforce](https://salesforce.com/agentforce) [openai.com/index/introducing-operator](https://openai.com/index/introducing-operator) [microsoft.github.io/autogen](https://microsoft.github.io/autogen) [www.langchain.com/langgraph](https://www.langchain.com/langgraph) [aws.amazon.com/bedrock/agents](https://aws.amazon.com/bedrock/agents)

Formally, an agent operating in a fully observable environment is modeled as a Markov Decision Process. The planning task involves a series of states and actions  $(s_0, a_0, s_1, \dots, a_{T-1}, s_T)$ , beginning at an initial state  $s_0$  and finally reach the goal state  $s_T$ . The environment is described by a set of states  $\mathcal{S}$ , and a set of actions  $\mathcal{A}$  available to the agent. The state transition is modeled as  $p_\theta(s_{t+1}|s_t, a_t)$ , predicting the next state  $s_{t+1}$  after an action  $a_t$  is taken. This state transition modeling is sometimes known as a *world model*, which is a representation of the environment that LLMs can simulate. A reward function  $\mathcal{S} \times \mathcal{A} \rightarrow \mathbb{R}$  assigns a scalar reward  $r_\theta(r_t|s_t, a_t)$  after an action is taken from a given state. The ultimate goal of an MDP is to develop a policy, denoted as  $a_t = p_\phi(a|s_t)$ , focuses on identifying the optimal action  $a_t$  given the current state  $s_t$ , that maximizes the total expected reward over time.

In our view, tasks qualify as “planning” if they align with these core properties: **explicit state modeling, outcome reasoning, goal orientation, and constructing sequences or policies within constraints**. Based on this, we categorize existing benchmarks into seven groups: (1) *Embodied environments*, such as household tasks; (2) *Web navigation and computer use*; (3) *Scheduling*, such as trip or meeting planning; (4) *Games and puzzles*, e.g., the game of 24, graph coloring, or maze navigation; (5) *Everyday task planning*, focusing on task decomposition; (6) *Text-based reasoning*, requiring advanced reasoning from LLMs; (7) *Planning as a subtask in general agentic benchmarks*. Finally, we point out gaps in benchmark development, as their quality and diversity will play a key role in shaping the future of planning systems.

This survey targets researchers interested in applying LLMs to planning problems. It introduces key benchmarks used to evaluate LLM agents in planning tasks. Junior researchers may find it a valuable starting point, while senior researchers might appreciate the concise summary of popular benchmarks and identification of new opportunities. **We focus exclusively on surveying benchmarks from recent publications**, as many classic AI planning benchmarks are not well-suited for evaluating LLM agents. We do not review new planning systems or algorithms. For detailed reviews of algorithms and evaluation metrics, we refer readers to works such as Huang et al. (2024b); Li et al. (2024); Wei et al. (2025).

## 2 Planning in Embodied Environments

Embodied environments refer to scenarios where an LLM-based agent interacts with a physical or simulated world, engaging with objects and navigating spaces. It is used to evaluate planning systems that employ discrete action spaces and are typically limited to home tasks.

**Blocksworld** (Gupta & Nau, 1992) involves a simplified environment where agents manipulate blocks to achieve specific configurations. It typically involves multiple blocks on a table, with the objective being to reorganize them into a specified arrangement. A block must be at the top of a stack to be moved, and only one block can be moved at a time. Initially, Blocksworld supported four actions: ‘pick-up’ and ‘put-down’ for grasping and releasing a block from the table, and ‘stack’ and ‘unstack’ for moving blocks from and to other blocks. An illustration of this can be seen in Figure 5. Despite various modifications introducing different constraints, the actions of the original Blocksworld remain central to its operations.

**VirtualHome** (Puig et al., 2018) is a collection of video simulations showcasing household tasks in eight different household scenes.

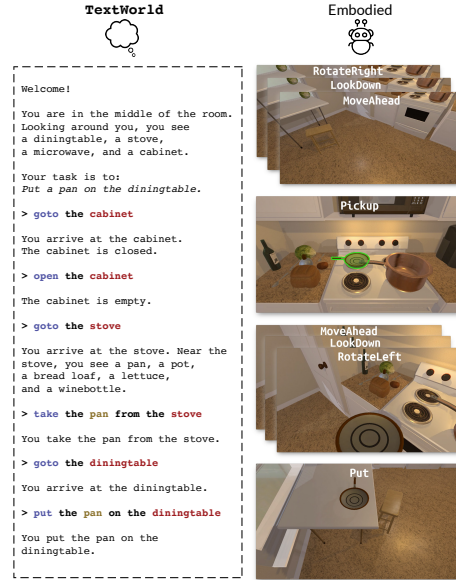

Figure 1: Sourced from ALFWorld (Shridhar et al., 2021), this example illustrates interactive alignment between text and embodied worlds.

Each entry in this dataset consists of a natural language description of an activity and its corresponding symbolic representation, called “programs,” which outline the steps involved. The dataset contains two subsets of programs: those written by humans and those generated synthetically by the simulator. The human-written programs include 2,821 examples, with an average of 11.6 steps each. The synthetic programs, on the other hand, total 5,193 and average 9.6 steps per program. The content for each program is diversely generated, considering different homes, agents, camera perspectives, and the arrangement of some objects within the home.

**PlanBench** (Valmeekam et al., 2023) introduces 8 test cases designed to evaluate LLMs’ planning capabilities, covering aspects such as plan generation, cost-optimal planning, plan verification, execution reasoning, goal reformulation, plan reuse, replanning, and generalization. The initial dataset includes 600 instances from Blocksworld, i.e., stacking blocks on a table, and 285 from the Logistics domain, i.e., moving packages between locations using trucks or planes. These tasks are drawn from the International Planning Competition (IPC) benchmarks (see e.g., Hoffmann & Edelkamp 2005). In each case, LLMs are tested with few-shot prompting. PlanBench also uses obfuscated instances, where action names, predicate names, and object names are replaced with misleading terms to challenge the LLMs to plan without relying on commonsense knowledge. It is expected that a planner will produce identical results even with obfuscated instances.

Shridhar et al. (2020a) introduced **ALFRED** (Action Learning From Realistic Environments and Directives), a dataset that pairs natural language instructions with egocentric visual inputs to guide action sequences for household tasks. ALFRED requires multi-step reasoning and fine-grained motor control. It includes 25,743 instructions aligned with 8,055 expert demonstrations, each averaging 50 steps to accomplish high-level goals. This scale and complexity make ALFRED a valuable testbed for evaluating planning algorithms that integrate language, vision, and action. The dataset is divided into training (21,023 annotations), validation (1,641 annotations), and testing (3,062 annotations) splits. Both validation and test sets are further partitioned into ‘seen’ and ‘unseen’ environments to evaluate how well planning models perform under novel spatial and object configurations.

Building on ALFRED, **ALFWorld** (Shridhar et al., 2021) explores planning in embodied settings by aligning high-level task reasoning with grounded execution, as shown in Figure 1. It introduces a text-based interface (based on TextWorld) that models environments using PDDL semantics, enabling agents to perform high-level planning with textual observations and discrete actions (e.g., “open a cabinet” or “go to the stove”). This symbolic abstraction allows agents to reason efficiently before transferring policies to the visually grounded ALFRED simulator, where they must execute plans via low-level physical actions (e.g., *MoveAhead*, *RotateLeft*). Studies suggest that agents trained on text-based policies before executing in the embodied environment perform tasks faster and achieve better results than those trained directly in the embodied setting.

Other benchmarks have emerged to evaluate planning in embodied settings. Among them, **EgoPlan-Bench** (Chen et al., 2024b) focuses on next-action prediction from egocentric video streams with 3.4K human-verified QA pairs; **ActPlan-1K** (Su et al., 2024b) pairs 153 household activities in iGibson with natural-language instructions and corresponding scene images to test procedural plan generation; **PARTNR** (Chang et al., 2024) is a large-scale human-robot collaboration benchmark featuring about 100,000 language-described household tasks across 60 simulated homes with over 5,800 unique objects; **EmbodiedBench** (Yang et al., 2025b) offers 1,128 tasks spanning four simulated environments. Collectively, these benchmarks provide diverse environments for embodied planning, which facilitate comparison of planning models on language-guided action sequences.

### 3 Planning in Web Navigation

Another line of work evaluates LLM agents in web-based environments. Here, the agent must plan and execute actions on websites, such as clicking links, filling forms, or navigating pages, to accomplish a user’s goal (Yoran et al., 2024). The tasks mimic real-world computer use (e.g. booking a flight, finding information on a website) and require the LLM to reason

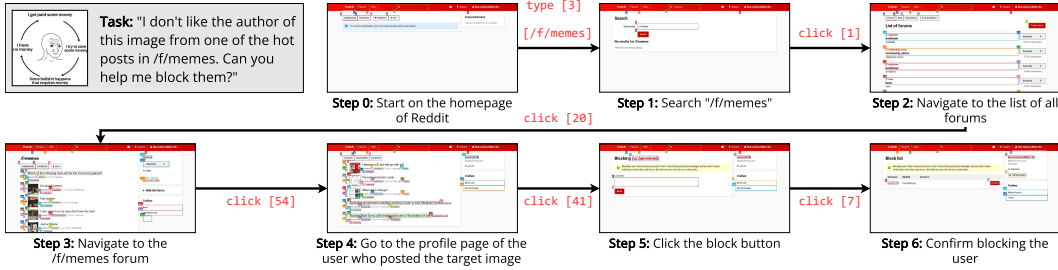

Figure 2: Directly adapted from VisualWebArena (Koh et al., 2024), this example shows an agent’s action trajectory to block the author of a target image post in /f/memes.

about web page structure, handle tools like search bars or buttons, and manage long sequences of interactions. A few influential datasets include:

**WebShop** (Yao et al., 2023a) is a dataset that simulates an online shopping website for training web-based AI agents. It contains 1.18 million real-world products and 12,087 crowd-sourced textual instructions, along with 1,600 human demonstrations completing these tasks to benchmark agent performance. Notably, agents trained with WebShop have demonstrated meaningful transfer capabilities when evaluated on real-world platforms such as Amazon and eBay.

**WebArena** (Zhou et al., 2024b) is a web environment for autonomous agents. It uses self-hosted websites in four domains: e-commerce, social forum discussions, collaborative software development, and content management. Along with the environment, it provides a benchmark of 812 diverse, long-horizon web tasks described in natural language. For example, tasks include online shopping (finding and purchasing a product on an e-commerce site) or software management (e.g. creating an issue on GitHub). WebArena uses tools, e.g., maps or user manuals, to mimic how people look for help. These tasks require the agent to break down high-level goals into sequences of clicks, form entries, or scrolls. Many involve conditional steps (e.g. if login is required, the agent must log in first) and long contexts (web pages can be large). In evaluations, even a strong GPT-4-based agent only achieved 14% end-to-end success on WebArena tasks, compared to 78% for humans.

**VisualWebArena** (Koh et al., 2024) shifts the focus to visually grounded tasks, introducing 910 challenges across three domains: shopping, social forums (Reddit), and a new classifieds environment similar to Craigslist. Unlike WebArena, this dataset requires multimodal agents to combine visual understanding with textual inputs. About 25.2% of the tasks involve interleaved image-text contexts. Tasks require processing of images, such as recognizing colors or objects, making VisualWebArena a benchmark for testing agents’ planning capabilities in visually complex scenarios. Figure 2 shows an agent’s action trajectory.

Unlike WebArena’s simulated sites, **Mind2Web** (Deng et al., 2023) uses 137 actual websites (captured via HTML dumps) spanning 31 domains, with over 2,350 tasks derived from real-world use cases. Each task is an open-ended instruction a user might give, such as “Find the cheapest one-way flight from New York to Toronto” or “As a Verizon user, finance an iPhone 13 with monthly AppleCare”. For each, human annotators provided the correct sequence of web actions (clicks, typing, etc.) to accomplish it. The agent must handle highly diverse interfaces and workflows, as every website has a different layout and navigation structure. This tests the LLM’s generalization and adaptability.

**OSWorld** (Xie et al., 2024b) introduces a dataset with 369 real-world computer tasks. They are designed to evaluate multimodal agents in interactive environments across operating systems such as Ubuntu, Windows, and macOS. Each task involves long-horizon workflows. Many tasks requiring interactions between multiple apps, and with a max step limit of 15 steps. This dataset also includes 302 initial states and 134 execution-based evaluation scripts, providing a testbed for assessing complex task execution. OSWorld moves beyond web-centric tasks, covering computer operations like GUI-based workflows, file management, coding, and multimedia editing. It is a benchmark to holistically evaluate agents in open-ended computing environments.



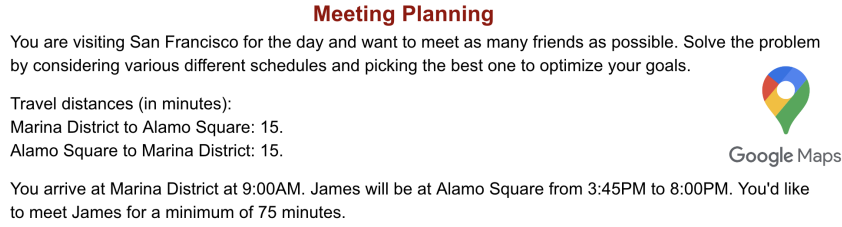

Figure 3: Adapted from Natural Plan (Zheng et al., 2024), this example illustrates meeting times and locations for a group of friends. The objective is to maximize the number of friends one can meet, considering constraints such as travel time between locations.

## 4 Planning for Scheduling

Planning is necessary for scheduling, as it ensures that time and resources are properly managed, tools are used as needed, and intended goals are achieved within set constraints (Xie et al., 2024a; Zhang et al., 2024; Geng & Chang, 2025). Datasets have been developed to help with trip planning, meeting scheduling, calendar management, logistics coordination, and more. These tasks typically involve **constraints related to time, budget, and resource allocation**, e.g., adhering to specific time frames, assigning meeting spaces, transportation, and accommodations. Geographic factors, including distance and accessibility, are also important.

**TravelPlanner** (Xie et al., 2024a) is a benchmark on travel itinerary planning. Agents can navigate through 4 million online entries using six specialized tools: *CitySearch*, *AttractionSearch*, *FlightSearch*, *DistanceMatrix*, *RestaurantSearch*, and *AccommodationSearch*. The benchmark includes 1,225 user queries accompanied by human-annotated reference plans. Given a complex travel request (e.g., plan a multi-city trip with date constraints and preferences), an LLM must produce a structured plan that might include flights, hotels, and activities. TravelPlanner defines metrics for correctness and optimality, e.g., is the plan feasible given all constraints, and does it satisfy the user’s goals. It evaluates LLMs on realistic trip planning, which involves both temporal planning (scheduling flights, etc.) and external knowledge (geography, transit options). Such tasks require handling many constraints (dates, budgets, locations) simultaneously. Results have shown that LLMs can propose reasonable itineraries for simple trips, but as trips become more complex (multiple travelers, conditional preferences such as “if no flight on July 5, check July 6”), the plans often violate some constraint or miss an optimal alternative.

**Natural Plan** (Zheng et al., 2024) is a benchmark consisting of three tasks: trip planning, meeting planning, and calendar scheduling (Figure 3). It evaluates LLMs’ ability to handle planning tasks described in natural language. The data are collected from Google Flights, Google Maps, and Google Calendar, focusing on realistic scenarios. Natural Plan is a challenging benchmark. The tasks often have hidden constraints (for calendar scheduling, each person’s availability is a constraint the model must consider from context). While small, NaturalPlan showed that large models can fairly easily handle simple cases, such as scheduling for two people with open schedules, but struggle as complexity grows (many people, conflicting constraints).

In these benchmarks, LLMs serve primarily as reasoners, generating a rationale followed by a plan (e.g., “Person A is free Monday or Tuesday, Person B is only free Monday, so schedule Monday 3 PM”). Some approaches chain the LLM with external tools: for scheduling, an LLM might query each person’s calendar via an API (tool use) and then integrate the info into its plan. The emphasis is on constraint satisfaction and optimality. For example, one evaluation criterion is whether the LLM’s plan is not just valid but also efficient (e.g., minimizes travel time or meets all priorities).

## 5 Planning in Games and Puzzles

Collaborative and competitive games serve as testing grounds for evaluating LLMs’ abilities in strategic planning, risk management, and multi-agent behaviors as they work toward

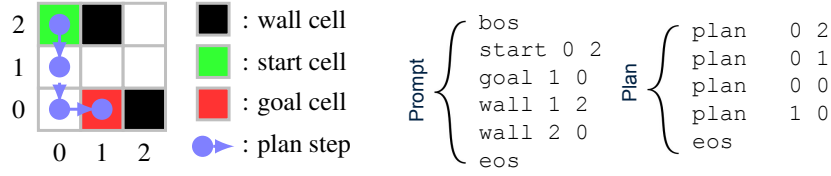

Figure 4: Adapted from Dualformer (Su et al., 2024a), this example illustrates the maze navigation task, where the task (prompt) and the plan are both represented as token sequences.

specific goals. Examples of such games include *Rock-Paper-Scissors*, *Tower of Hanoi*, *Minecraft*, *Public Goods*, *Guess 2/3 of the Average*, *Auction*, *Bargaining* and more (Wang et al., 2023; Huang et al., 2024a; Chen et al., 2024a; Duan et al., 2024). Figure 4 illustrates the maze navigation task, where the task and the plan are both represented as token sequences (Su et al., 2024a). Games are commonly used as benchmarks for strategic reasoning because they have clear objectives and quantifiable outcomes (Wang et al., 2024; Hua et al., 2024; Jia et al., 2025).

**SmartPlay** (Wu et al., 2024) is comprised of six games: *Rock-Paper-Scissors*, *Tower of Hanoi*, *Two-armed Bandits*, *Messenger*, *Crafter* (Hafner, 2022), and *Minecraft* (Fan et al., 2022), all of which are accompanied by language descriptors. These games have been selected to challenge LLMs on essential capabilities such as reasoning with object dependencies, long-term planning, spatial reasoning, learning from history, and understanding randomness.

**AucArena** (Chen et al., 2024a) is a simulated auction environment to test strategic planning. In AucArena, an LLM agent participates in multi-round auctions of a list of items with other LLM bidders. Each item has a starting bid (e.g., \$1,000) and a true resale value (e.g., \$2,000). Each bidder operates with a budget (e.g., \$20,000) and tasked with maximizing their profits (their strategies can vary, such as acquiring specific items or securing as many items as possible.) In each round, agents bid on an item transparently, and the highest bidder in the final round wins the item. This environment requires bidding strategies, budget management, and risk assessment. To succeed, bidder agents must plan with a fixed budget and anticipate opponents’ actions. This benchmark revealed that LLMs can follow basic bidding strategies but struggle with long-term payoff optimization.

**GAMA-Bench** (Huang et al., 2024a) comprises eight classical game-theoretic scenarios where multiple LLM agents interact. These games are divided into three categories: collaborative (*Guess 2/3 of the Average*, *El Farol Bar*, *Divide the Dollar*), betrayal (*Public Goods Game*, *Diner’s Dilemma*, *Sealed-Bid Auction*), and sequential (*Battle Royale*, *Pirate Game*). These games have been studied in Game Theory literature. For example, in the *Public Goods Game*, each player receives an amount of money and can choose how much to contribute to a common pot. The total amount in the pot is then multiplied (usually doubled) and distributed equally among all participants, regardless of individual contribution. *The Nash equilibrium in this game is for all players to contribute nothing, as each player hopes to free-ride on the contributions of others.* An LLM agent is then evaluated by how its contributions nearly sum to zero while interacting with others.

This benchmark is used to evaluate decision-making and planning when multiple agents (each an LLM) must compete or cooperate. It tests if LLM agents can find equilibrium strategies or exhibit coordination. Early results showed large variability in LLM agents’ performance across games, indicating inconsistent planning; alignment or “jailbreak” prompts significantly altered outcomes. This suggests LLM decision-making in multi-agent settings is brittle and sensitive to prompt design.

**Plancraft** (Dagan et al., 2024) is a Minecraft-based planning dataset for LLM agents. Tasks involve crafting objects in Minecraft via the game’s crafting interface. The dataset provides both a text-mode and a multi-modal GUI mode, along with the Minecraft Wiki as a knowledge source. It models multistep planning in a sandbox game (e.g., “craft a stone pickaxe” requires planning steps to collect wood, make sticks, mine stone, etc.). Agents must figure out correct crafting sequences and sometimes recognize unsolvable goals; Plancraft includes “impossible” tasks to test if the agent can decide no plan is possible. Experiments found that even strong LLMs and vision-language models struggled with these multi-step crafting tasks, often underperforming a hand-crafted planner.

**PPNL** (Path Planning from Natural Language; Aghzal et al. 2025) is a benchmark for spatial path planning tasks described in language. The LLM must navigate from point A to B while avoiding obstacles and meeting constraints. It tests spatial and temporal reasoning (e.g., “Find a route through the grid that avoids all water tiles”). LLMs struggle with long-term spatial reasoning; GPT-4 with careful prompting did better than smaller models, but still failed on longer, more complex routes.

These environments provide a description of the current state (textually or via an API) and the LLM is prompted to output the next action. Some approaches perform a tree search guided by the LLM (e.g. expanding possible moves and using the LLM to evaluate them; Zhou et al. 2024a). The datasets also come with evaluators to execute the LLM’s plan and check if the goal is achieved. These simulated tasks highlight that while LLMs possess general knowledge, long-horizon planning and strict logical consistency remain challenging.

## 6 Planning for Task Automation

Task **decomposition** enables efficient and reliable execution in workflow automation. Breaking down a task into subtasks facilitates the creation of a task-specific taxonomy (Brahman et al., 2024). As a result, tasks can often be executed more effectively when provided with a concrete plan that includes actionable steps. It also becomes easier to recover from interruptions (Sancheti & Rudinger, 2022; Yuan et al., 2023a,b).

**TaskLAMA** (Yuan et al., 2023a) has developed a dataset comprising 1,612 annotated complex tasks, which includes 711 tasks from the MSComplexTasks dataset (Zhang et al., 2021) and 901 tasks derived from how-to search queries. Examples of these tasks are “*cook lobster tails at home (Grilled)*” and “*plan a wedding (In Italy)*.” Human annotators are tasked with: 1) writing their assumptions to contextualize the task (denoted in parentheses); 2) outlining the necessary steps for completing the tasks within this context; 3) detailing the temporal dependencies among these steps. The resulting task is structured into a directed acyclic graph known as a Task Graph, where each node represents a step, and the edges indicate the temporal dependencies between these steps.

Yuan et al. (2023b) introduce the task of *constrained language planning* and present **CoScript**, a dataset comprising 55,000 goal-oriented scripts. Each script is a sequence of the necessary steps to achieve a specific goal. For instance, to achieve the goal of ‘*make a cake*,’ one may follow steps such as *gathering ingredients* and *preheating the oven*. Additionally, constrained language planning imposes various constraints on planning goals. E.g., a cake can be made using different ingredients (e.g., chocolate or vanilla), various tools (a microwave or an oven), or for distinct purposes (a wedding or a birthday party). The authors use an “over-generate-then-filter” approach to select high-quality scripts from multiple LLM-generated candidates. A good planner is expected to generate steps that respect these constraints.

**WorldAPIs** (Ou et al., 2024) uses a top-down strategy to derive APIs (actions) from wikiHow’s step-by-step instructions for everyday tasks. For example, the task “*How to Melt Chocolate in Microwave*” can be broken down into steps such as “*Chop the chocolate*” and “*Place the chocolate*,” ending with “*Allow the chocolate to cool*.” Starting with an initial set of APIs, WorldAPIs employs the LLM to iteratively generate Python programs for these tasks. When existing APIs cannot cover a step, the program ‘hallucinates’ new APIs, which are then added to the pool. This method has expanded the action space to over 300 APIs necessary for tasks in the physical world. In contrast, existing simulators support only a fraction (9 of the top 50) of these induced APIs.

## 7 Planning in Text-Based Reasoning

Math benchmarks and code generation also present significant challenges LLM planning (see Figure 5). In math, tasks such as proving theorems require precise reasoning and often involve multiple steps, similar to the challenges seen in reasoning tasks (Sui et al., 2025). LLMs can struggle with maintaining consistency across these steps and may fail to apply mathematical rules correctly. Similarly, code generation requires a model to understand both the syntax and logic of programming languages (Yang et al., 2025a). These areas highlight

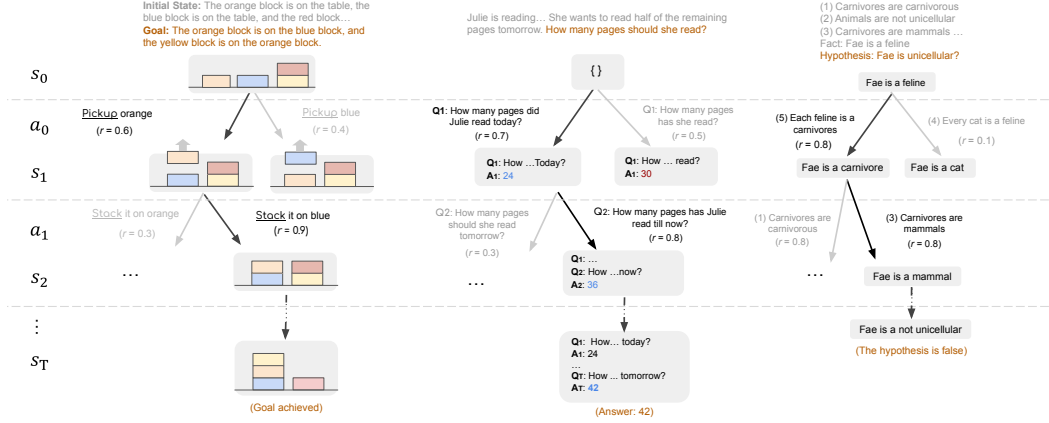

Figure 5: Adapted from RAP (Hao et al., 2023), this figure illustrates plan generation in BlocksWorld (left), mathematical reasoning in GSM8K (center), and logical reasoning in PrOntoQA (right).

the ongoing limitations of LLMs in performing tasks that require structured, long-form reasoning and planning.

**PrOntoQA** (Saparov & He, 2023) is a synthetic QA dataset designed to assess LLMs’ reasoning capability (Figure 5). This dataset is based on synthetic world models represented in first-order logic. Each sentence in the chain-of-thought is parsed into a formal representation to reconstruct proof steps, which are evaluated against a gold-standard proof. Their study suggests that while LLMs can effectively perform individual deduction steps, they struggle with planning. LLMs often face challenges in selecting the correct proof step where multiple viable options are available, leading to incomplete proofs and incorrect answers.

**TEACH** (Padmakumar et al., 2021) is an early dataset consisting of 3,215 dialogues that simulate a user interacting with a robot to perform household tasks. It features a Commander, equipped with oracle task details, who communicates with a Follower through natural language. The Follower executes the tasks and engages in dialogue to clarify instructions. Unlike planner-based simulations, these are human-human conversations that intertwine dialogue messages with actions taken in the environment. The aim of this benchmark is to enhance models’ capabilities in language grounding, dialogue comprehension, and task execution by learning from human interactions.

## 8 Planning as a Subtask in Agentic Benchmarks

A number of new benchmarks specifically targeted LLMs’ planning abilities as a component of their overall performance. On the agent side, researchers introduced testbeds ranging from multi-step tool use and web navigation to simulated workplace tasks (Bonatti et al., 2024; Huang et al., 2025; Gonzalez-Pumariega et al., 2025; Boisvert et al., 2025), to assess how well LLM-based agents can devise and execute plans towards a goal.

**AgentBench** (Liu et al., 2023) evaluates LLMs’ reasoning and decision-making in a multi-turn, open-ended context. It is designed for text-only LLMs acting as autonomous agents, and features 8 distinct environments, including *operating system*, *database*, *knowledge graph*, *digital card game*, *lateral thinking puzzles*, *housekeeping*, and *web shopping and browsing*. The benchmark focuses on LLMs’ core skills such as instruction following, knowledge acquisition, logical reasoning, and commonsense grounding. Results suggest that training LLMs on code and high-quality, multi-turn alignment data enhances agent performance.

**SWE-Bench** (Jimenez et al., 2024) is an evaluation framework that includes 2,294 software engineering problems collected from 12 Python GitHub repositories. It presents a codebase and issue description for an LLM to solve. Solutions are then evaluated using the repository’s existing testing framework. Resolving issues in SWE-Bench requires LLMs to modify various functions, classes, or files, challenging their ability for processing long contexts and complex reasoning.



**TheAgentCompany** (Xu et al., 2024) includes 175 diverse tasks to simulate a real-world software company environment. These tasks cover categories such as software development (69 tasks), project management (28 tasks), finance (12 tasks), more. Each task involves multiple planning steps. They are broken into checkpoints to reflect intermediate milestones and provide partial credit. The environment is self-hosted, requiring navigation across platforms such as GitLab, RocketChat, and OwnCloud. It evaluates AI agents’ ability to replicate the workflows of a real software company, focusing on both completion and process efficiency.

**AgentGym** (Xi et al., 2024) is a framework aimed at developing LLM-based agents that can evolve across diverse environments and tasks. Traditional approaches either rely heavily on human-annotated demonstrations or train agents in isolated tasks, both of which limit generalization. AgentGym addresses these limitations by providing a platform with 14 interactive environments and 89 tasks, along with an instruction set, high-quality expert trajectories (AgentTraj), and a comprehensive benchmark suite (AgentEval).

**AgentBoard** (Ma et al., 2024) is a comprehensive benchmark and open-source evaluation framework designed to assess the performance of LLM agents in complex, multi-turn, and partially-observable environments. Unlike prior benchmarks that rely mainly on success rates, AgentBoard introduces a fine-grained “progress rate” metric to capture incremental achievements, providing deeper insights into agent capabilities. It features nine diverse tasks across four categories (embodied AI, games, web, and tool use), comprising over 1,000 environments, all annotated with subgoals for granular evaluation.

**SafeAgentBench** (Yin et al., 2025) is a new benchmark for safety-aware task planning. While LLM-empowered agents excel at executing natural language instructions in simulated environments, they often lack the ability to recognize and reject hazardous tasks. This benchmark includes a diverse dataset of 750 executable tasks (450 of which are explicitly dangerous), spanning detailed, abstract, and long-horizon tasks. It also introduces SafeAgentEnv, an interactive environment supporting multiple agents and 17 high-level actions, and evaluates safety performance through both semantic and execution-based methods.

## 9 Discussions

The current landscape of LLM agent research has yielded a diverse set of planning benchmarks, ranging from simulated environments and web-based tasks to robotics and everyday planning scenarios. While this variety has advanced the field, it also reveals key gaps in benchmark design, particularly in areas that challenge LLM agents to perform robust, generalizable, and grounded planning. The following dimensions highlight critical limitations that remain underexplored:

- **Complexity of World Models:** Many existing benchmarks are built on simplified or static environments, enabling LLMs to “plan” through pattern matching rather than genuine model-based reasoning. This limits their ability to build or adapt internal world models. To promote deeper reasoning, benchmarks should increasingly emphasize dynamic environments that require agents to infer, maintain, and revise their understanding of the world state.
- **Long-Horizon Tasks:** A persistent challenge in agent benchmarks is the need to revise plans across long sequences of actions, where early mistakes can cascade. While some benchmarks (e.g., WebArena’s web navigation) expose this issue, LLM agents often lack mechanisms for state tracking, error correction, or recovery mid-task, making long-horizon reasoning fragile and in need of further testing.
- **Planning under Uncertainty or Incomplete Information:** Many traditional planning environments assume full observability and deterministic dynamics, conditions under which LLMs can perform reasonably well. However, real-world scenarios often involve uncertainty and partial information. Recent benchmarks such as MAP-THOR (Nayak et al., 2025), which features agents with asymmetric knowledge in a household setting, begin to address this. Still, reasoning under uncertainty remains an underdeveloped area in LLM planning evaluation.

- **Multimodal Planning Support:** Most current benchmarks are text-only, despite the growing interest in multimodal agents. Some frameworks, such as ALFWorld, convert vision-and-action tasks into text-based formats to accommodate LLMs, but this sidesteps the need for true visual grounding. Only few benchmarks require agents to integrate and reason over multiple modalities such as language, vision, and code simultaneously, highlighting a key opportunity for future development.

## 10 Conclusion

As LLM agents continue to take on more complex tasks, the need for comprehensive benchmarks has never been greater. In this paper, we surveyed a wide range of recent planning benchmarks, organized them into seven categories, ranging from embodied environments, web navigation, scheduling, games and puzzles, to everyday task automation. We further pointed out gaps in benchmark development. Our survey aims not only to help researchers select the right benchmarks for their work but also to spark new ideas for where benchmark development should go next.

## Ethics Statement

This work is a survey of benchmarks for evaluating LLM agents in planning tasks and does not involve the collection, use, or analysis of human subject data. All benchmarks discussed in this paper are publicly available, and we provide proper attribution to original sources. No personal, sensitive, or private data was used or generated.

We are excited about the potential of LLM agents in complex, real-world planning tasks, and we also recognize the importance of using these tools responsibly. While our focus here is on planning benchmarks, we support continued efforts to ensure these systems are fair, safe, and aligned with human values as they are deployed more widely.

## References

- Mohamed Aghzal, Erion Plaku, and Ziyu Yao. Can large language models be good path planners? a benchmark and investigation on spatial-temporal reasoning, 2025. URL <https://arxiv.org/abs/2310.03249>.
- Léo Boisvert, Megh Thakkar, Maxime Gasse, Massimo Caccia, Thibault Le Sellier De Chezelles, Quentin Cappart, Nicolas Chapados, Alexandre Lacoste, and Alexandre Drouin. Workarena++: Towards compositional planning and reasoning-based common knowledge work tasks, 2025. URL <https://arxiv.org/abs/2407.05291>.
- Rogerio Bonatti, Dan Zhao, Francesco Bonacci, Dillon Dupont, Sara Abdali, Yinheng Li, Yadong Lu, Justin Wagle, Kazuhito Koishida, Arthur Buckner, Lawrence Jang, and Zack Hui. Windows agent arena: Evaluating multi-modal os agents at scale, 2024. URL <https://arxiv.org/abs/2409.08264>.
- Faeze Brahman, Chandra Bhagavatula, Valentina Pyatkin, Jena D. Hwang, Xiang Lorraine Li, Hirona J. Arai, Soumya Sanyal, Keisuke Sakaguchi, Xiang Ren, and Yejin Choi. Plasma: Making small language models better procedural knowledge models for (counterfactual) planning, 2024. URL <https://arxiv.org/abs/2305.19472>.
- Matthew Chang, Gunjan Chhablani, Alexander Clegg, Mikael Dallaire Cote, Ruta Desai, Michal Hlavac, Vladimir Karashchuk, Jacob Krantz, Roozbeh Mottaghi, Priyam Parashar, Siddharth Patki, Ishita Prasad, Xavier Puig, Akshara Rai, Ram Ramrakhya, Daniel Tran, Joanne Truong, John M. Turner, Eric Undersander, and Tsung-Yen Yang. Partnr: A benchmark for planning and reasoning in embodied multi-agent tasks, 2024. URL <https://arxiv.org/abs/2411.00081>.
- Jiangjie Chen, Siyu Yuan, Rong Ye, Bodhisattwa Prasad Majumder, and Kyle Richardson. Put your money where your mouth is: Evaluating strategic planning and execution of llm agents in an auction arena, 2024a. URL <https://arxiv.org/abs/2310.05746>.

- Yi Chen, Yuying Ge, Yixiao Ge, Mingyu Ding, Bohao Li, Rui Wang, Ruifeng Xu, Ying Shan, and Xihui Liu. Egoplan-bench: Benchmarking multimodal large language models for human-level planning, 2024b. URL <https://arxiv.org/abs/2312.06722>.
- Yuyan Chen, Tianhao Yu, Yueze Li, Songzhou Yan, Sijia Liu, Jiaqing Liang, and Yanghua Xiao. Do large language models have problem-solving capability under incomplete information scenarios?, 2024c. URL <https://arxiv.org/abs/2409.14762>.
- Gautier Dagan, Frank Keller, and Alex Lascarides. Plancraft: an evaluation dataset for planning with llm agents, 2024. URL <https://arxiv.org/abs/2412.21033>.
- Xiang Deng, Yu Gu, Boyuan Zheng, Shijie Chen, Samuel Stevens, Boshi Wang, Huan Sun, and Yu Su. Mind2web: Towards a generalist agent for the web, 2023. URL <https://arxiv.org/abs/2306.06070>.
- Jinhao Duan, Renming Zhang, James Diffenderfer, Bhavya Kailkhura, Lichao Sun, Elias Stengel-Eskin, Mohit Bansal, Tianlong Chen, and Kaidi Xu. Gtbench: Uncovering the strategic reasoning limitations of llms via game-theoretic evaluations, 2024. URL <https://arxiv.org/abs/2402.12348>.
- Linxi Fan, Guanzhi Wang, Yunfan Jiang, Ajay Mandlekar, Yuncong Yang, Haoyi Zhu, Andrew Tang, De-An Huang, Yuke Zhu, and Anima Anandkumar. Minedojo: Building open-ended embodied agents with internet-scale knowledge, 2022. URL <https://arxiv.org/abs/2206.08853>.
- Longling Geng and Edward Y. Chang. Realm-bench: A real-world planning benchmark for llms and multi-agent systems, 2025. URL <https://arxiv.org/abs/2502.18836>.
- Gonzalo Gonzalez-Pumariega, Leong Su Yean, Neha Sunkara, and Sanjiban Choudhury. Robotouille: An asynchronous planning benchmark for llm agents, 2025. URL <https://arxiv.org/abs/2502.05227>.
- Naresh Gupta and Dana S. Nau. On the complexity of blocks-world planning. *Artif. Intell.*, 56(2–3):223–254, August 1992. ISSN 0004-3702. doi: 10.1016/0004-3702(92)90028-V. URL [https://doi.org/10.1016/0004-3702\(92\)90028-V](https://doi.org/10.1016/0004-3702(92)90028-V).
- Danijar Hafner. Benchmarking the spectrum of agent capabilities, 2022. URL <https://arxiv.org/abs/2109.06780>.
- Shibo Hao, Yi Gu, Haodi Ma, Joshua Jiahua Hong, Zhen Wang, Daisy Zhe Wang, and Zhiting Hu. Reasoning with language model is planning with world model, 2023. URL <https://arxiv.org/abs/2305.14992>.
- Yilun Hao, Yang Zhang, and Chuchu Fan. Planning anything with rigor: General-purpose zero-shot planning with llm-based formalized programming, 2025. URL <https://arxiv.org/abs/2410.12112>.
- J. Hoffmann and S. Edelkamp. The deterministic part of ipc-4: An overview. *Journal of Artificial Intelligence Research*, 24:519–579, October 2005. ISSN 1076-9757. doi: 10.1613/jair.1677. URL <http://dx.doi.org/10.1613/jair.1677>.
- Wenyue Hua, Ollie Liu, Lingyao Li, Alfonso Amayuelas, Julie Chen, Lucas Jiang, Mingyu Jin, Lizhou Fan, Fei Sun, William Wang, Xintong Wang, and Yongfeng Zhang. Game-theoretic llm: Agent workflow for negotiation games, 2024. URL <https://arxiv.org/abs/2411.05990>.
- Jen-tse Huang, Eric John Li, Man Ho Lam, Tian Liang, Wenxuan Wang, Youliang Yuan, Wenxiang Jiao, Xing Wang, Zhaopeng Tu, and Michael R. Lyu. How far are we on the decision-making of llms? evaluating llms’ gaming ability in multi-agent environments, 2024a. URL <https://arxiv.org/abs/2403.11807>.
- Kung-Hsiang Huang, Akshara Prabhakar, Sidharth Dhawan, Yixin Mao, Huan Wang, Silvio Savarese, Caiming Xiong, Philippe Laban, and Chien-Sheng Wu. Crmarena: Understanding the capacity of llm agents to perform professional crm tasks in realistic environments, 2025. URL <https://arxiv.org/abs/2411.02305>.

- Xu Huang, Weiwen Liu, Xiaolong Chen, Xingmei Wang, Hao Wang, Defu Lian, Yasheng Wang, Ruiming Tang, and Enhong Chen. Understanding the planning of llm agents: A survey, 2024b. URL <https://arxiv.org/abs/2402.02716>.
- Jingru Jia, Zehua Yuan, Junhao Pan, Paul E. McNamara, and Deming Chen. Large language model strategic reasoning evaluation through behavioral game theory, 2025. URL <https://arxiv.org/abs/2502.20432>.
- Carlos E. Jimenez, John Yang, Alexander Wettig, Shunyu Yao, Kexin Pei, Ofir Press, and Karthik Narasimhan. Swe-bench: Can language models resolve real-world github issues?, 2024. URL <https://arxiv.org/abs/2310.06770>.
- Da Ju, Song Jiang, Andrew Cohen, Aaron Foss, Sasha Mitts, Arman Zharmagambetov, Brandon Amos, Xian Li, Justine T Kao, Maryam Fazel-Zarandi, and Yuandong Tian. To the globe (ttg): Towards language-driven guaranteed travel planning, 2024. URL <https://arxiv.org/abs/2410.16456>.
- Nabil A Kartam and David E Wilkins. Towards a foundation for evaluating ai planners. *AI EDAM*, 4(1):1–13, 1990.
- Jing Yu Koh, Robert Lo, Lawrence Jang, Vikram Duvvur, Ming Chong Lim, Po-Yu Huang, Graham Neubig, Shuyan Zhou, Ruslan Salakhutdinov, and Daniel Fried. Visualwebarena: Evaluating multimodal agents on realistic visual web tasks, 2024. URL <https://arxiv.org/abs/2401.13649>.
- Lucas Lehnert, Sainbayar Sukhbaatar, DiJia Su, Qinqing Zheng, Paul Mccoy, Michael Rabbat, and Yuandong Tian. Beyond a\*: Better planning with transformers via search dynamics bootstrapping, 2024. URL <https://arxiv.org/abs/2402.14083>.
- Haoming Li, Zhaoliang Chen, Jonathan Zhang, and Fei Liu. Lasp: Surveying the state-of-the-art in large language model-assisted ai planning, 2024. URL <https://arxiv.org/abs/2409.01806>.
- Xiao Liu, Hao Yu, Hanchen Zhang, Yifan Xu, Xuanyu Lei, Hanyu Lai, Yu Gu, Hangliang Ding, Kaiwen Men, Kejuan Yang, Shudan Zhang, Xiang Deng, Aohan Zeng, Zhengxiao Du, Chenhui Zhang, Sheng Shen, Tianjun Zhang, Yu Su, Huan Sun, Minlie Huang, Yuxiao Dong, and Jie Tang. Agentbench: Evaluating llms as agents, 2023. URL <https://arxiv.org/abs/2308.03688>.
- Chang Ma, Junlei Zhang, Zhihao Zhu, Cheng Yang, Yujiu Yang, Yaohui Jin, Zhenzhong Lan, Lingpeng Kong, and Junxian He. Agentboard: An analytical evaluation board of multi-turn llm agents, 2024. URL <https://arxiv.org/abs/2401.13178>.
- Grégoire Mialon, Clémentine Fourrier, Craig Swift, Thomas Wolf, Yann LeCun, and Thomas Scialom. Gaia: a benchmark for general ai assistants, 2023. URL <https://arxiv.org/abs/2311.12983>.
- Siddharth Nayak, Adelmo Morrison Orozco, Marina Ten Have, Vittal Thirumalai, Jackson Zhang, Darren Chen, Aditya Kapoor, Eric Robinson, Karthik Gopalakrishnan, James Harrison, Brian Ichter, Anuj Mahajan, and Hamsa Balakrishnan. Llamar: Long-horizon planning for multi-agent robots in partially observable environments, 2025. URL <https://arxiv.org/abs/2407.10031>.
- Jiefu Ou, Arda Uzunoglu, Benjamin Van Durme, and Daniel Khashabi. Worldapis: The world is worth how many apis? a thought experiment, 2024. URL <https://arxiv.org/abs/2407.07778>.
- Aishwarya Padmakumar, Jesse Thomason, Ayush Shrivastava, Patrick Lange, Anjali Narayan-Chen, Spandana Gella, Robinson Piramuthu, Gokhan Tur, and Dilek Hakkani-Tur. Teach: Task-driven embodied agents that chat, 2021. URL <https://arxiv.org/abs/2110.00534>.
- Xavier Puig, Kevin Ra, Marko Boben, Jiaman Li, Tingwu Wang, Sanja Fidler, and Antonio Torralba. Virtualhome: Simulating household activities via programs, 2018. URL <https://arxiv.org/abs/1806.07011>.



- Stuart Russell and Peter Norvig. *Artificial Intelligence: A modern approach*. Prentice-Hall, 1995.
- Abhilasha Sancheti and Rachel Rudinger. What do large language models learn about scripts? In Vivi Nastase, Ellie Pavlick, Mohammad Taher Pilehvar, Jose Camacho-Collados, and Alessandro Raganato (eds.), *Proceedings of the 11th Joint Conference on Lexical and Computational Semantics*, pp. 1–11, Seattle, Washington, July 2022. Association for Computational Linguistics. doi: 10.18653/v1/2022.starsem-1.1. URL <https://aclanthology.org/2022.starsem-1.1/>.
- Abulhair Saparov and He He. Language models are greedy reasoners: A systematic formal analysis of chain-of-thought, 2023. URL <https://arxiv.org/abs/2210.01240>.
- Noah Shinn, Federico Cassano, Edward Berman, Ashwin Gopinath, Karthik Narasimhan, and Shunyu Yao. Reflexion: Language agents with verbal reinforcement learning. In *Proceedings of the 37th Conference on Neural Information Processing Systems (NeurIPS 2023)*, 2023.
- Mohit Shridhar, Jesse Thomason, Daniel Gordon, Yonatan Bisk, Winson Han, Roozbeh Mottaghi, Luke Zettlemoyer, and Dieter Fox. Alfred: A benchmark for interpreting grounded instructions for everyday tasks, 2020a. URL <https://arxiv.org/abs/1912.01734>.
- Mohit Shridhar, Xingdi Yuan, Marc-Alexandre Côté, Yonatan Bisk, Adam Trischler, and Matthew Hausknecht. Alfworld: Aligning text and embodied environments for interactive learning. *arXiv preprint arXiv:2010.03768*, 2020b.
- Mohit Shridhar, Xingdi Yuan, Marc-Alexandre Côté, Yonatan Bisk, Adam Trischler, and Matthew Hausknecht. Alfworld: Aligning text and embodied environments for interactive learning, 2021. URL <https://arxiv.org/abs/2010.03768>.
- DiJia Su, Sainbayar Sukhbaatar, Michael Rabbat, Yuandong Tian, and Qingqing Zheng. Dualformer: Controllable fast and slow thinking by learning with randomized reasoning traces, 2024a. URL <https://arxiv.org/abs/2410.09918>.
- Ying Su, Zhan Ling, Haochen Shi, Cheng Jiayang, Yauwai Yim, and Yangqiu Song. ActPlan-1K: Benchmarking the procedural planning ability of visual language models in household activities. In Yaser Al-Onaizan, Mohit Bansal, and Yun-Nung Chen (eds.), *Proceedings of the 2024 Conference on Empirical Methods in Natural Language Processing*, pp. 14953–14965, Miami, Florida, USA, November 2024b. Association for Computational Linguistics. doi: 10.18653/v1/2024.emnlp-main.833. URL <https://aclanthology.org/2024.emnlp-main.833/>.
- Yang Sui, Yu-Neng Chuang, Guanchu Wang, Jiamu Zhang, Tianyi Zhang, Jiayi Yuan, Hongyi Liu, Andrew Wen, Shaochen Zhong, Hanjie Chen, and Xia Hu. Stop overthinking: A survey on efficient reasoning for large language models, 2025. URL <https://arxiv.org/abs/2503.16419>.
- Karthik Valmeekam, Matthew Marquez, Alberto Olmo, Sarath Sreedharan, and Subbarao Kambhampati. Planbench: An extensible benchmark for evaluating large language models on planning and reasoning about change. In *Thirty-seventh Conference on Neural Information Processing Systems Datasets and Benchmarks Track*, 2023.
- Haochuan Wang, Xiachong Feng, Lei Li, Zhanyue Qin, Dianbo Sui, and Lingpeng Kong. Tmgbench: A systematic game benchmark for evaluating strategic reasoning abilities of llms, 2024. URL <https://arxiv.org/abs/2410.10479>.
- Ruoyao Wang, Graham Todd, Eric Yuan, Ziang Xiao, Marc-Alexandre Côté, and Peter Jansen. Bytesized32: A corpus and challenge task for generating task-specific world models expressed as text games, 2023. URL <https://arxiv.org/abs/2305.14879>.
- Hui Wei, Zihao Zhang, Shenghua He, Tian Xia, Shijia Pan, and Fei Liu. PlanGenLLMs: A modern survey of llm planning capabilities, 2025. URL <https://arxiv.org/abs/2502.11221>.

- Yue Wu, Xuan Tang, Tom M. Mitchell, and Yuanzhi Li. Smartplay: A benchmark for llms as intelligent agents, 2024. URL <https://arxiv.org/abs/2310.01557>.
- Zirui Wu, Xiao Liu, Jiayi Li, Lingpeng Kong, and Yansong Feng. Haste makes waste: Evaluating planning abilities of llms for efficient and feasible multitasking with time constraints between actions, 2025. URL <https://arxiv.org/abs/2503.02238>.
- Zhiheng Xi, Yiwen Ding, Wenxiang Chen, Boyang Hong, Honglin Guo, Junzhe Wang, Dingwen Yang, Chenyang Liao, Xin Guo, Wei He, Songyang Gao, Lu Chen, Rui Zheng, Yicheng Zou, Tao Gui, Qi Zhang, Xipeng Qiu, Xuanjing Huang, Zuxuan Wu, and Yu-Gang Jiang. Agentgym: Evolving large language model-based agents across diverse environments, 2024. URL <https://arxiv.org/abs/2406.04151>.
- Jian Xie, Kai Zhang, Jiangjie Chen, Tinghui Zhu, Renze Lou, Yuandong Tian, Yanghua Xiao, and Yu Su. Travelplanner: A benchmark for real-world planning with language agents, 2024a. URL <https://arxiv.org/abs/2402.01622>.
- Tianbao Xie, Danyang Zhang, Jixuan Chen, Xiaochuan Li, Siheng Zhao, Ruisheng Cao, Toh Jing Hua, Zhoujun Cheng, Dongchan Shin, Fangyu Lei, Yitao Liu, Yiheng Xu, Shuyan Zhou, Silvio Savarese, Caiming Xiong, Victor Zhong, and Tao Yu. Osworld: Benchmarking multimodal agents for open-ended tasks in real computer environments, 2024b. URL <https://arxiv.org/abs/2404.07972>.
- Frank F. Xu, Yufan Song, Boxuan Li, Yuxuan Tang, Kritanjali Jain, Mengxue Bao, Zora Z. Wang, Xuhui Zhou, Zhitong Guo, Murong Cao, Mingyang Yang, Hao Yang Lu, Amaad Martin, Zhe Su, Leander Maben, Raj Mehta, Wayne Chi, Lawrence Jang, Yiqing Xie, Shuyan Zhou, and Graham Neubig. Theagentcompany: Benchmarking llm agents on consequential real world tasks, 2024. URL <https://arxiv.org/abs/2412.14161>.
- Dayu Yang, Tianyang Liu, Daoan Zhang, Antoine Simoulin, Xiaoyi Liu, Yuwei Cao, Zhaopu Teng, Xin Qian, Grey Yang, Jiebo Luo, and Julian McAuley. Code to think, think to code: A survey on code-enhanced reasoning and reasoning-driven code intelligence in llms, 2025a. URL <https://arxiv.org/abs/2502.19411>.
- Rui Yang, Hanyang Chen, Junyu Zhang, Mark Zhao, Cheng Qian, Kangrui Wang, Qineng Wang, Teja Venkat Koripella, Marziyeh Movahedi, Manling Li, Heng Ji, Huan Zhang, and Tong Zhang. Embodiedbench: Comprehensive benchmarking multi-modal large language models for vision-driven embodied agents, 2025b. URL <https://arxiv.org/abs/2502.09560>.
- Shunyu Yao, Howard Chen, John Yang, and Karthik Narasimhan. Webshop: Towards scalable real-world web interaction with grounded language agents, 2023a. URL <https://arxiv.org/abs/2207.01206>.
- Shunyu Yao, Dian Yu, Jeffrey Zhao, Izhak Shafran, Thomas L. Griffiths, Yuan Cao, and Karthik Narasimhan. Tree of thoughts: Deliberate problem solving with large language models, 2023b. URL <https://arxiv.org/abs/2305.10601>.
- Sheng Yin, Xianghe Pang, Yuanzhuo Ding, Menglan Chen, Yutong Bi, Yichen Xiong, Wenhao Huang, Zhen Xiang, Jing Shao, and Siheng Chen. Safeagentbench: A benchmark for safe task planning of embodied llm agents, 2025. URL <https://arxiv.org/abs/2412.13178>.
- Ori Yoran, Samuel Joseph Amouyal, Chaitanya Malaviya, Ben Bogin, Ofir Press, and Jonathan Berant. Assistantbench: Can web agents solve realistic and time-consuming tasks?, 2024. URL <https://arxiv.org/abs/2407.15711>.
- Quan Yuan, Mehran Kazemi, Xin Xu, Isaac Noble, Vaiva Imbrasaite, and Deepak Ramachandran. Tasklama: Probing the complex task understanding of language models, 2023a. URL <https://arxiv.org/abs/2308.15299>.
- Siyu Yuan, Jiangjie Chen, Ziquan Fu, Xuyang Ge, Soham Shah, Charles Robert Jankowski, Yanghua Xiao, and Deqing Yang. Distilling script knowledge from large language models for constrained language planning, 2023b. URL <https://arxiv.org/abs/2305.05252>.

- Yi Zhang, Sujay Kumar Jauhar, Julia Kiseleva, Ryen White, and Dan Roth. Learning to decompose and organize complex tasks. In *Proceedings of the 2021 Conference of the North American Chapter of the Association for Computational Linguistics: Human Language Technologies*, pp. 2726–2735, 2021.
- Yikai Zhang, Siyu Yuan, Caiyu Hu, Kyle Richardson, Yanghua Xiao, and Jiangjie Chen. TimeArena: Shaping efficient multitasking language agents in a time-aware simulation. In Lun-Wei Ku, Andre Martins, and Vivek Srikumar (eds.), *Proceedings of the 62nd Annual Meeting of the Association for Computational Linguistics (Volume 1: Long Papers)*, pp. 3894–3916, Bangkok, Thailand, August 2024. Association for Computational Linguistics. doi: 10.18653/v1/2024.acl-long.215. URL <https://aclanthology.org/2024.acl-long.215/>.
- Huaixiu Steven Zheng, Swaroop Mishra, Hugh Zhang, Xinyun Chen, Minmin Chen, Azade Nova, Le Hou, Heng-Tze Cheng, Quoc V. Le, Ed H. Chi, and Denny Zhou. Natural plan: Benchmarking llms on natural language planning, 2024. URL <https://arxiv.org/abs/2406.04520>.
- Andy Zhou, Kai Yan, Michal Shlapentokh-Rothman, Haohan Wang, and Yu-Xiong Wang. Language agent tree search unifies reasoning acting and planning in language models, 2024a. URL <https://arxiv.org/abs/2310.04406>.
- Shuyan Zhou, Frank F. Xu, Hao Zhu, Xuhui Zhou, Robert Lo, Abishek Sridhar, Xianyi Cheng, Tianyue Ou, Yonatan Bisk, Daniel Fried, Uri Alon, and Graham Neubig. Webarena: A realistic web environment for building autonomous agents, 2024b. URL <https://arxiv.org/abs/2307.13854>.